

QUICK START FlushMinder TF Automatic Dual Flush Kit Instructions

This general instruction sheet covers the basic installation procedure for this kit. Since toilet configurations vary widely, your particular installation may require additional steps and/or hardware. For more information, please visit our website at <http://www.water-saver.org> or email your questions to support@water-saver.org.



Water Saver Products, LLC

"Home of the FlushSaver DIY Kits"

◊◊◊ AFM4TF1QS Rev B © WSP 2021

Thank You for choosing Water Saver Products !!!

OVERVIEW

This electronic dual-flush toilet conversion system fits most Top Flush Push Button toilets and is FULLY AUTOMATIC. Upon toilet use, a computerized human-presence Sensor measures the "time-at-the-toilet" and then activates a Flush Motor inside the tank which lifts the flapper valve for either a half-flush (#1) or full-flush (#2) as required. The presence detection is self-calibrating and the half and full flush cycles can be adjusted with a simple Magnetic Wand and Adjustable Push Rod (both included). The Sensor and Flush Motor installation and setup are quick and easy with minimal tools, NO TANK REMOVAL or plumbing skills required. Both the Sensor and Flush Motor are moisture sealed and run on 6 standard AA alkaline batteries (included) for up to 1 year or 5,000 worry-free flushes. Saves water and improves sanitation - perfect for children, the elderly, public toilets or any high-use bathroom where flushing delinquency is a problem.

PREPARATION

Before attempting installation, please read these Quick Start Instructions thoroughly, familiarize yourself with your specific toilet configuration and gather any required tools. Ensure that the Sensor can be mounted just above the toilet tank with no frontal obstructions within a range of 4 ¼ feet and that the Flush Motor will fit down inside the toilet tank roughly above the flapper valve without interference. The battery compartment inside the Sensor requires a small Philips screwdriver to open since the cover is tightly sealed against moisture with a silicon gasket. The Sensor unit itself can be mounted with either its attached double-sided tape or by using the included wall fasteners or other similar fasteners as desired, so a drill and appropriate bit may be required as well.

COMPONENTS

(Objects not to relative scale for clarity)

DETECTION EYE

SENSOR

MAGNETIC TARGET

LED INDICATORS

DETECTION BEAM

PUSH BUTTON
(Remains Functional)

FLUSH MOTOR

ADJUSTABLE PUSH ROD

SINGLE / DUAL FLUSH VALVE



FLUSH CYCLE
SETUP MODE

PRESENCE
DETECTION

LOW BATTERIES

ACCESSORIES

(Objects not to relative scale for clarity)

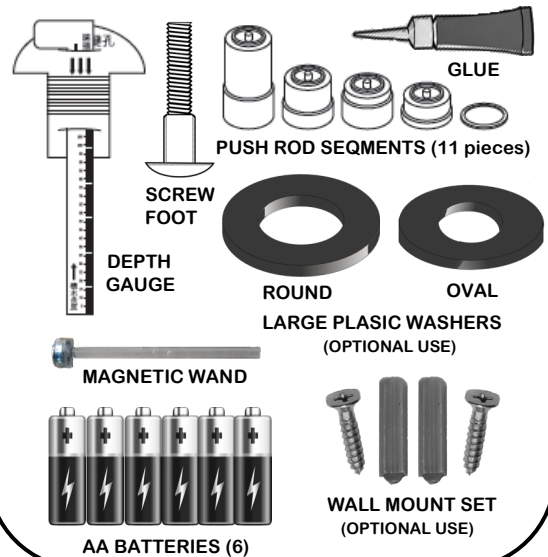

INSTALLATION (over)



INSTALLATION

1



Position the Sensor on the wall behind the tank such that it is high enough to "see" above any obstacles, yet low enough to detect a person sitting on the toilet.

TAPE MOUNT - or - SCREW MOUNT

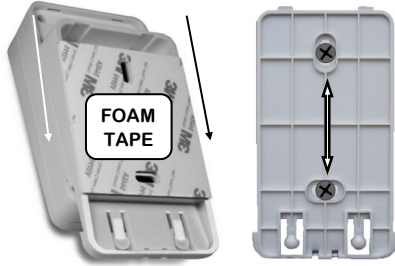

Mount the Sensor using the attached foam tape on the back plate or remove the back plate by sliding downward and mount using the appropriate wall anchors, then place the Sensor back on the wall.

⇒ DO NOT INSTALL BATTERIES YET !!! SLIDE OFF

2

Lift off the toilet tank lid, flip it over, unscrew the retaining nut on the push button and remove it. Replace the tank lid, drop in the Depth Gauge and measure the distance from the base of the Flush Motor to the top of the Flush Valve.

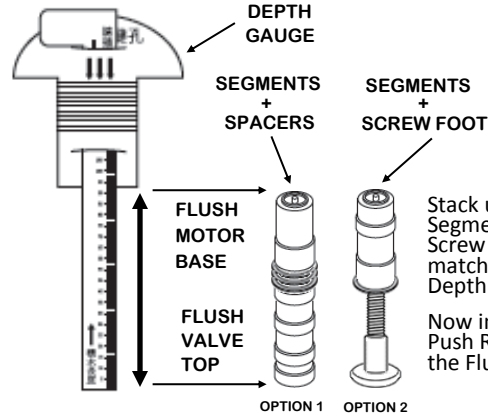

Stack up the Push Rod Segments, Spacers and/or Screw Foot as preferred to match the height on the Depth Gauge.

Now insert the completed Push Rod assembly into the Flush Motor Mount.

Depending on the tank lid hole size and flush valve type, select from the large washers to position the Flush Motor and Push Rod over top of the single flush actuator tab or centered over the dual flush tabs.

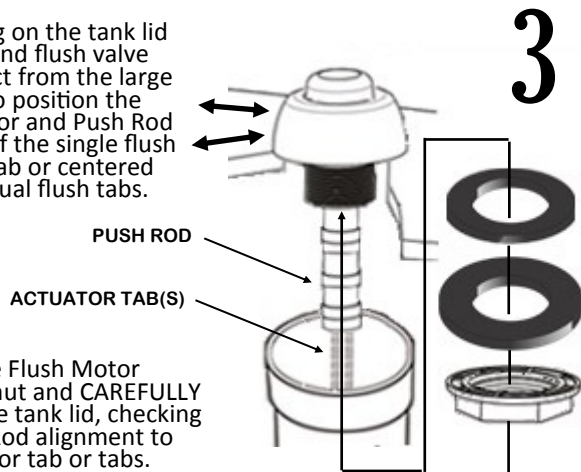

Secure the Flush Motor retaining nut and CAREFULLY replace the tank lid, checking the Push Rod alignment to the actuator tab or tabs.

⇒ WASHERS ARE OPTIONAL - NOT REQUIRED IN SOME INSTALLATIONS

4

Remove the Sensor from its wall plate by sliding upward and off, then remove the battery cover with a small Philips screwdriver. Install the 6 AA batteries and immediately hold the unit back against its mount while standing to the side (out of the detection beam) until the Presence Detection LED stops flashing.

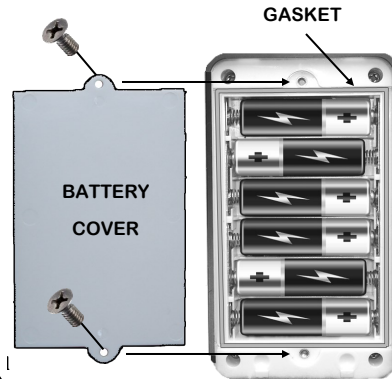

Now check that the silicone gasket inside the battery compartment is in position, replace the battery cover and then reinstall the Sensor unit back onto its wall mount.

⇒ FLUSH MOTOR MAY CYCLE ANYTIME DURING THIS STEP

ADJUSTMENTS

5



Stand to the right out of the detection beam and adjust the Half Flush cycle time by holding the Magnetic Wand against the right side Magnetic Target until the desired water release is achieved.

Note the speed and distance of the Flush Motor up/down cycle and adjust accordingly. The Full Flush will automatically cycle to the maximum up/down limits.



MAGNETIC WAND

FULL CYCLE



⇒ FLAPPER VALVE SHOULD NOT FULLY OPEN ON EITHER CYCLE

TESTING

6

Stand in front of the Sensor until the Detection LED flashes for about 15 secs and then step aside to activate a test Half Flush. Observe the mechanics and alignment of the Flush Motor as it cycles and make any further adjustments.



Once all adjustments are made and testing is complete, go back and tack the Push Rod Segments together with a tiny dab of Super Glue at each joint to secure it.

INSTALLATION AND SETUP COMPLETE!

NOTE: Anytime the batteries are replaced or the Sensor range needs to be recalibrated, simply repeat steps 5 & 6. To prevent false detection and random flushes, keep any obstacles or mirrored surfaces out of the Detection Beam.

SPECIFICATIONS

Sensor: 4.75Lx2.75Wx2.55D inches (120x70x65 mm)
 Detection Range: 0 - 31.5 +/- 4.0 inches (80 +/- 10 cm)
 Detection Clearance: 51 inches (130 cm)
 Flush Motor: Servo Jackscrew (stall protected)

Half Flush Timer: 10 - 60 secs
 Full Flush Timer: > 60 secs
 Maximum Flush Cycle: 10 secs
 Autoflush: 1 per week

Power: 6 AA Batteries
 Type: Alkaline, Lithium, Rechargeable Lithium
 Protection: Moisture Sealed
 Life: 1 Year or 5,000 flushes (approximate)