

QUICK START PaperSaver Slimline Bidet Instructions

This general instruction sheet covers the basic installation procedure for this kit. Depending on your specific bathroom configuration, further installation steps and/or tools may be required. For additional information please visit our website at <https://www.water-saver.org> or email your questions to support@water-saver.org.



Water Saver Products, LLC

"Home of the FlushSaver DIY Kits"

◆◆ PSBD-1SC1 Rev A © WSP 2020 ◆◆

Thank You for choosing Water Saver Products !!!

OVERVIEW

PaperSaver Slimline Bidet fits most standard Two Piece toilets (with separate tank and bowl) and is VERY EASY TO OPERATE. Sleek and thin design minimally protrudes from the toilet and blends well with most bathroom decors. Connects easily to the existing toilet water line with the included t-valve and stainless braided hose. Uses NO ELECTRICITY or BATTERIES, so is TOTALLY SAFE in any bathroom environment. Single horizontal water control knob is large with bold print and works the same when turned in either direction . . . first to clean the nozzle and then further around to spray. The nozzle spray angle adjusts with a convenient lever tab near the control knob and is also designed with a unique twist out mount for easy cleaning or replacement.

Anyone with basic DIY home plumbing experience can install this simple bidet kit . . . MINIMUM COMMON TOOLS REQUIRED.

PREPARATION

Before attempting installation, please read these Quick Start Instructions in full, familiarize yourself with your specific bathroom configuration and gather any required tools and hardware. This kit and these instructions apply to a typical toilet and water supply configuration, but since every bathroom is different, some installations may require additional steps or assistance from a professional plumber. Ensure that the bidet will fit the bowl width and shape of the toilet by positioning it over the toilet seat bolts and adjusting its rotating mounts accordingly. For most installations, the only tool required is a standard adjustable wrench, but since toilet plumbing hardware can vary widely, additional tools, fittings or adapters may be required beyond what is supplied with this kit.

COMPONENTS

(Items not to relative scale for clarity)

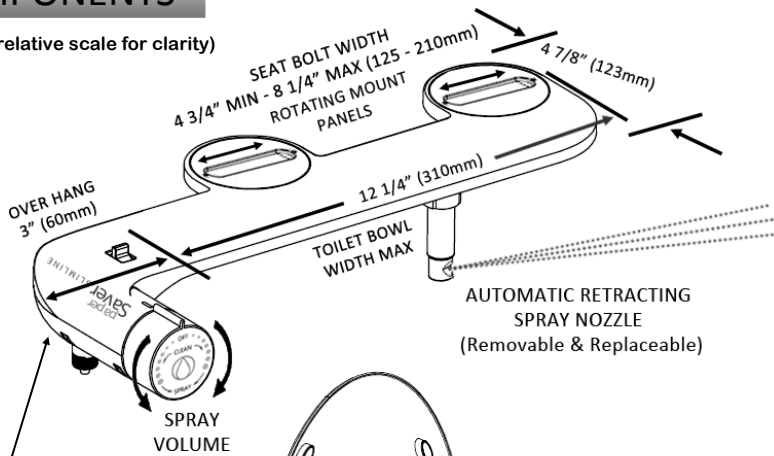

paper Saver SLIMLINE

BRAIDED HOSE

T-VALVE

TOILET WATER LINE

STANDARD TWO PIECE TOILET (SEPARATE TANK AND BOWL)

INSTALLATION EXAMPLE

⇒ BATHROOM CONFIGURATIONS VARY WIDELY

ACCESSORIES

(Items not to relative scale for clarity)

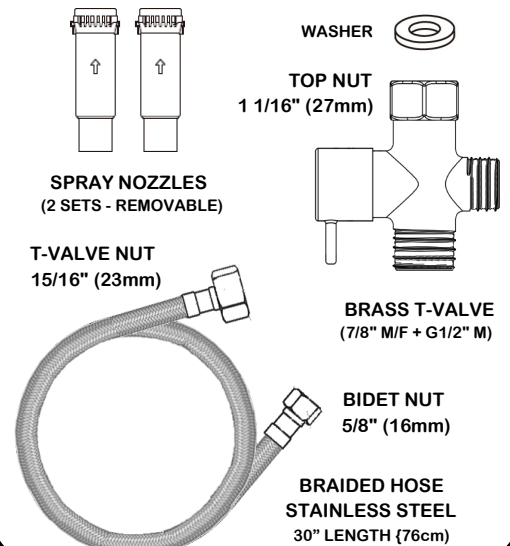

INSTALLATION (over)



INSTALLATION

COLLAR →
O-RING →
NOZZLE →

Check nozzle for proper assembly of o-ring and lock collar as shown.

With the nozzle and nozzle mount arrows pointing toward each other, align the nozzle tabs to the mount, insert and twist to the right until it locks into place.

⇒ NOTE SPARE NOZZLE INCLUDED

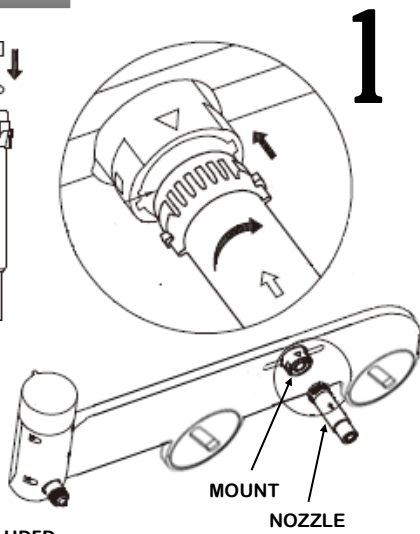

1

Remove the toilet seat bolts and slide the bidet underneath the seat mounts while positioning the bidet mounts to align with the same bolt holes.

paper Saver SLIMLINE

Note how the bidet mounts can be rotated as required to achieve the proper fit. Once in position, reinstall the seat bolts and snug down.

⇒ DO NOT OVERTIGHTEN MOUNT BOLTS

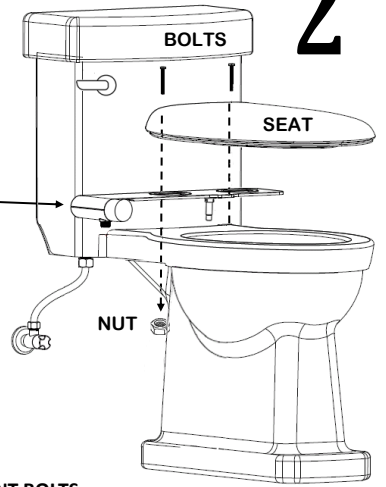

2

Place a towel under the toilet tank water line to catch any water that drips down during removal. Turn off the water spigot, then flush the toilet and hold the handle down to drain out as much water as possible.

WATER SPIGOT
TOWEL

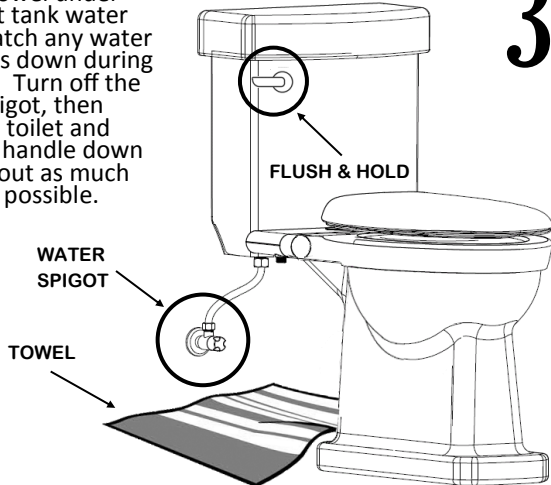

3

Disconnect the toilet water line at the tank filler valve inlet. Be prepared for a small amount of water to run out from the tank filler valve upon removal. Connect the included t-valve and washer to the filler valve inlet and reattach the water line to it.

FILLER VALVE INLET
WASHER
T-VALVE
WATER LINE

⇒ HAND SNUG ONLY - DO NOT WRENCH TIGHTEN YET

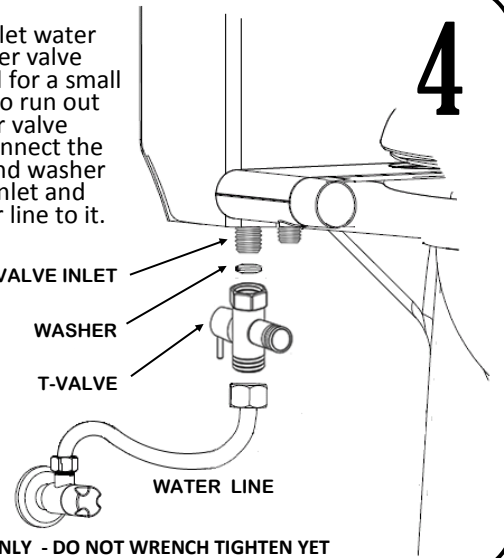

4

Connect the included braided hose from the t-valve outlet port to the bidet inlet port. Orient the position of the t-valve as desired.

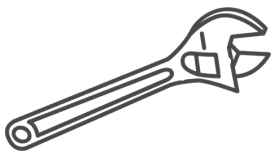

Carefully tighten all fittings, but do not over tighten. Usually 1/8 to 1/4 turn past hand snug is enough.

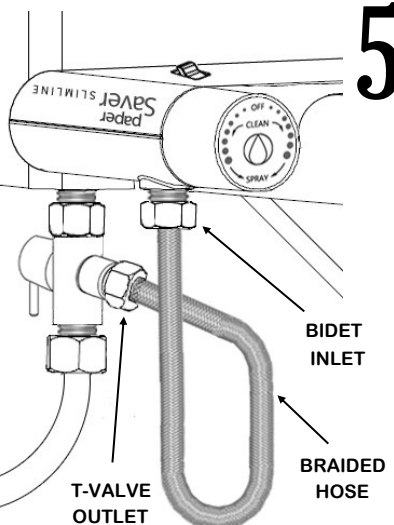

5

OPERATION

Turn the water spigot and t-valve on SLOWLY to check for leaks. Then place your right hand in front of the spray nozzle to catch the spray and rotate the control knob either way with your left hand. Note how the clean and spray volume relates to the position of the knob.

NOZZLE ANGLE

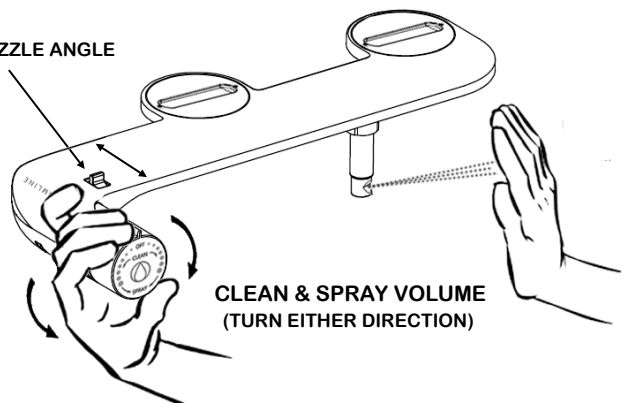

CLEAN & SPRAY VOLUME
(TURN EITHER DIRECTION)

MAINTENANCE

The spray nozzle will self clean each time the control knob is rotated into the CLEAN position. If a more thorough cleaning is required, remove the nozzle by rotating it to the left to unlock it from the mount.

Certain water conditions with high mineral content may cause the nozzle orifices to clog over time. Soak in vinegar or descaler then use a soft brush to remove deposits.

NOTE: Turn off the t-valve when not in use for extended periods as a precaution against leaks !!!