

In an effort to save natural resources, we have supplied more detailed instructions and an installation video on our website www.water-saver.org. We realize that not everyone has a fast Internet connection so we are also supplying these basic instructions that should suffice in most instances and get you through this simple project.

1 Getting Ready

Make sure you have a compatible flush valve



1. Turn off the water supply.
2. Flush the toilet.
3. Remove the rubber flapper.
4. Remove the flush handle. It has a reverse thread and you will need pliers to remove it.
5. Remove the flush body from the base of the new dual flush valve as shown to the right.

2 Next

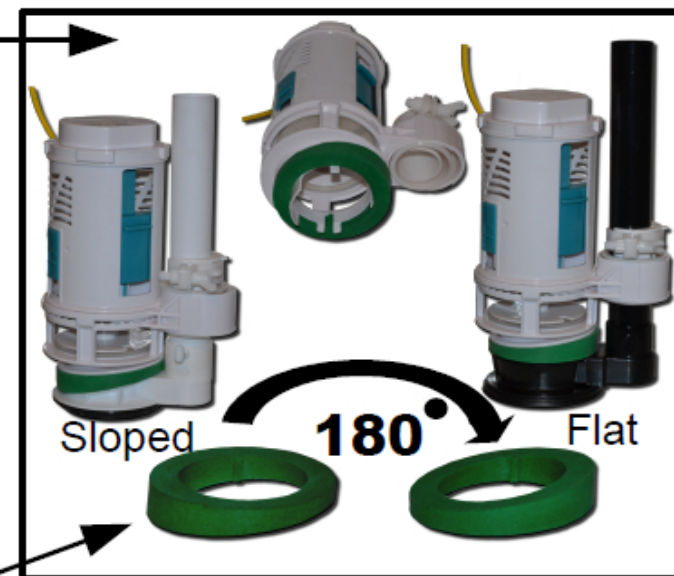
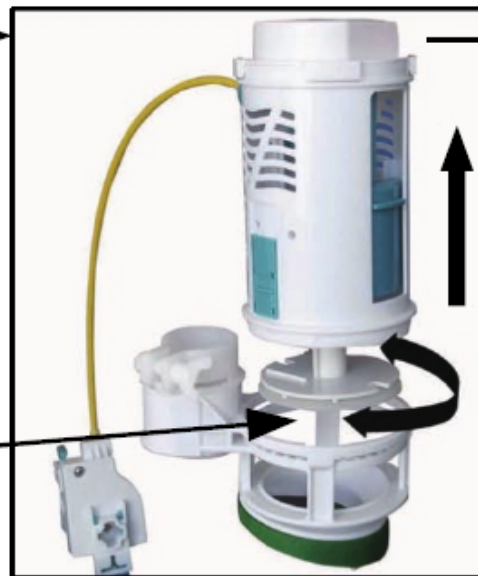

4 Installation

1. If the overflow tube is a reduced diameter, use the removable adapter.
2. Lower the new valve base onto the old flush valve.
3. Align the tabs under the green gasket to fit inside the flush valve opening.
4. Once in place, hold the new flush base down with one hand while tightening the wing nut with the other.
5. Reinstall the new flush body onto the flush base.

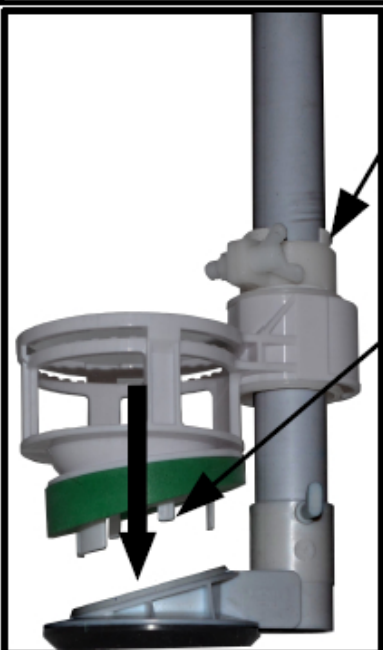

6 Adjustment

Set the half and full flush levers on the new flush valve body all the way up. Then Fill the toilet tank to the original factory recommended height. If necessary, adjust the sliders downward until a sufficient flush is achieved with both the half and full flushes. Install the decals and you are done!

3 If necessary, remove and turn the green gasket over for a flat valve installation.



Button or Handle?

5

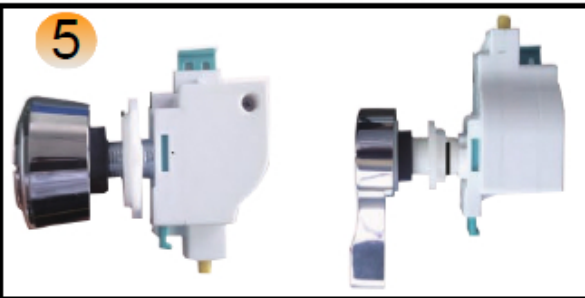

Both the button and the handle operate from different openings on the same control box. Determine which one works better for you and install it in the handle opening in your tank. Depending on the size of the opening, the square rubber spacer may or may not be used in the installation.

Need more help?

www.water-saver.org or support@water-saver.org